

INSTALLATION INSTRUCTION

Items included

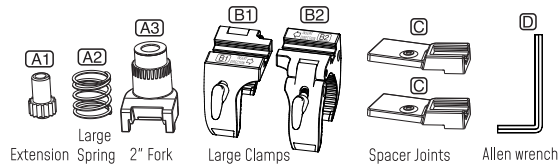

Tool not included

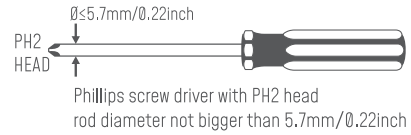

1

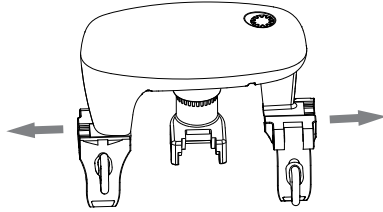

Remove the clamps by sliding the clamps

2

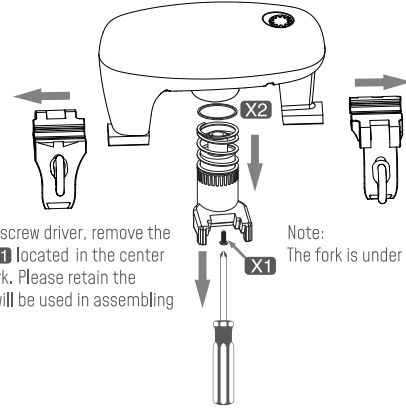

Using the Phillips screw driver, remove the retaining screw **X1** located in the center opening of the fork. Please retain the gasket **X2** as it will be used in assembling the larger fork.

Note:
The fork is under tension from the spring

3

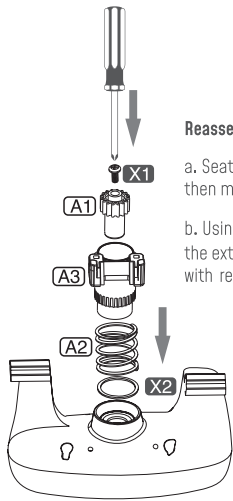

Reassemble the 2" fork with the parts in this kit

a. Seat the gasket **X2** onto the shaft opening, then mount the spring **A2** with the 2" fork **A3**.

b. Using the Phillips screw driver, securely screw in the extension **A1** into center opening of the fork with retained screw **X1**.

4

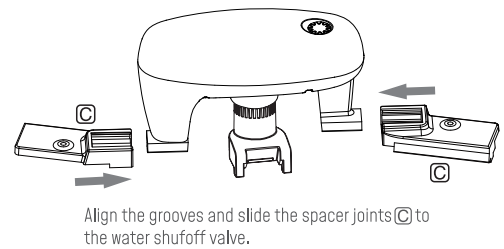

Align the grooves and slide the spacer joints **C** to the water shutoff valve.

5

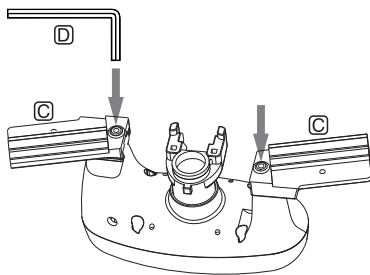

Use the Allen wrench **D** and tighten the Allen screws from the bottom side of the spacer joints **C**. This secures the spacer joints to the water shutoff valve.

6

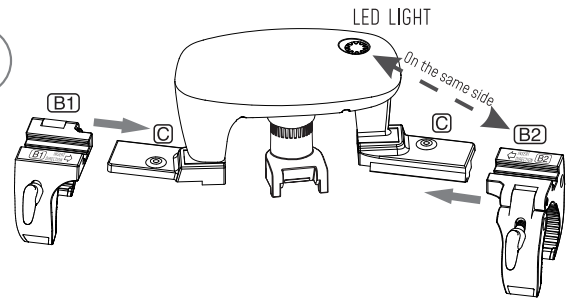

Align the grooves and slide the large clamps to the spacer joints **C**. Note: Large clamp **B2** should be attached on the side of the LED light. Both clamp knob handles should face towards the same direction.

7

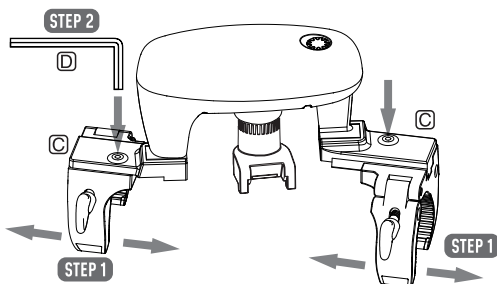

STEP 1 Slide the clamps on either direction to avoid any pipe elbow/obstacles, see example:

STEP 2 Use the Allen wrench **D** and tighten the allen screws from the top side of the spacer joint **C**. This secures the spacer joint to the large clamps.

Example: How to adjust for close elbows

